

VRT 2/15 VERSION

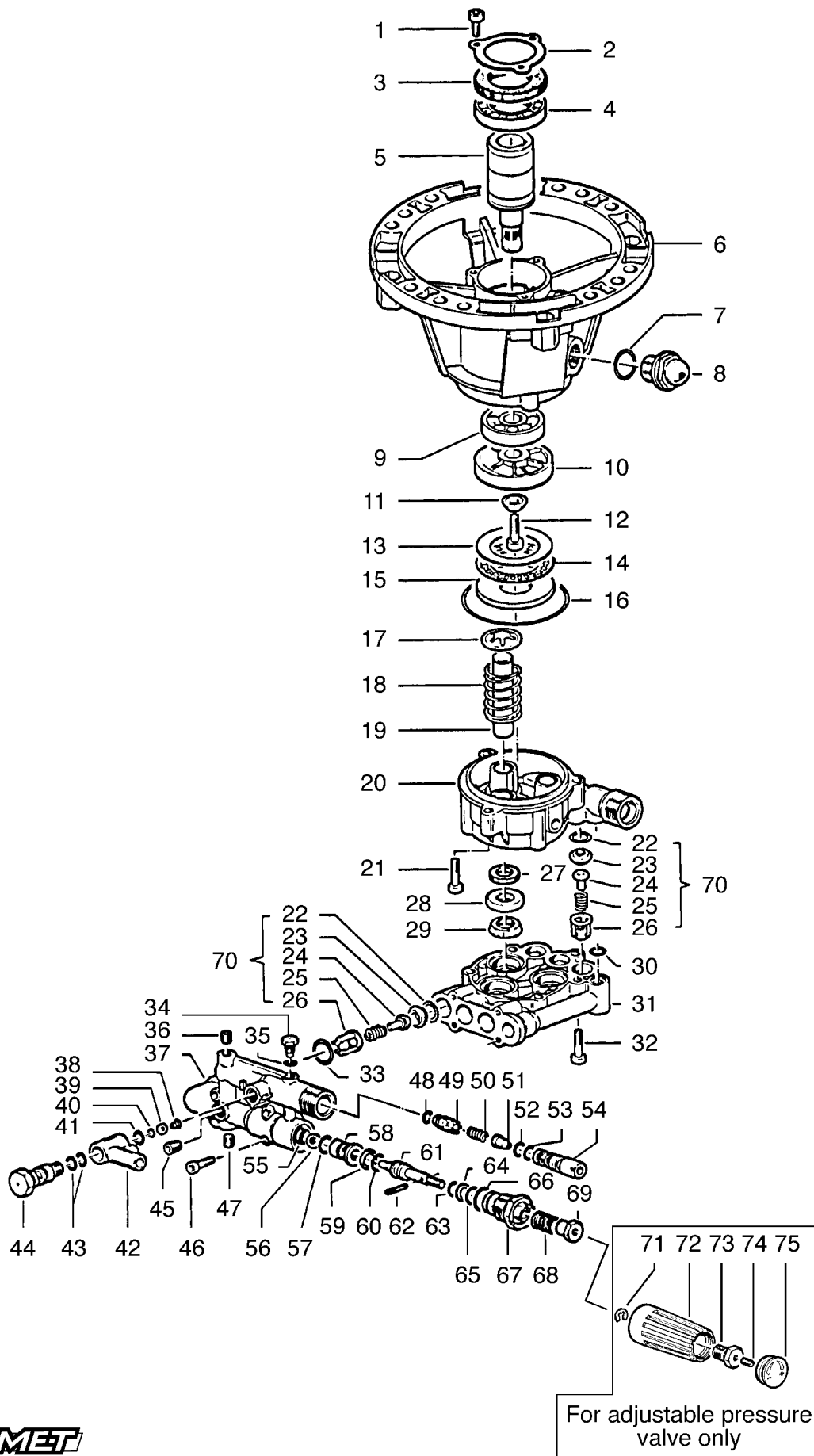

VRT 2/15 VERSION

Standard version

ITEM	PART No.	KIT	DESCRIPTION	Qty.	MODELS
1	3625.0045.00		SCREW M5X10	3	
2	1004.0017.00		CRANKCASE COVER	1	
3	0019.0075.00		OIL SEAL 35X62X 7 mm	1	
4	0438.0015.00		BALL BEARING 35X62X14mm	1	
5	0004.0022.00		CRANKSHAFT	1	
6	3002.0507.00		FLANGE	1	
7	1210.0071.00		O-RING 1,78X 20,35 mm	1	
8	3201.0005.00		OIL INDICATOR 1/2GAS	1	
9	0438.0058.00		BALL BEARING 17X47X14 mm	1	
10	0001.0358.00		WOBBLE PLATE 8,5°	1	
11	2812.0066.00		WASHER	1	
12	3609.0034.00		SCREW M6X18	1	
13	2816.0020.00		THRUST BEARING 40X60X1mm	1	
14	0436.0014.00		AXIAL BEARING 40X60X3	1	
15	2816.0021.00		THRUST BEARING 27X60X6mm	1	
16	1210.0391.00		O-RING 2,62X75,87mm	1	
17	0009.0195.00		RING	3	
18	1802.0174.00		SPRING	3	
19	2409.0069.00		PISTON Ø14 mm	3	
20	2432.0014.00		HOUSING	1	
21	3609.0100.00		SCREW M6X35	4	
22	1210.0393.00		O-RING 2,0X12 mm	6	
23	3009.0118.00		VALVE SEAT	6	
24	3604.0026.00		VALVE PLATE	6	
25	1802.0175.00		SPRING	6	
26	1205.0031.00		VALVE GUIDE	6	
27	0019.0058.00		OIL SEAL 14X22,2X5/7 mm	3	
28	0009.0201.00		RING	3	
29	1241.0033.00		PACKING 14X22X6 mm	3	
30	1210.0041.00		O-RING 1,78X 8,73 mm	1	
31	3218.0111.00		PUMP HEAD	1	
32	3609.0100.00		SCREW M6X35	4	
33	1210.0392.00		O-RING 2,0X16 mm	4	
34	3605.0087.00		SPECIAL SCREW M6	1	
35	1210.0220.00		O-RING 2,0X4 mm	1	
36	3200.0017.00		GRUB SCREW 1/8X8 mm	1	
37	0424.0320.00		VALVE HOUSING	1	
38	1802.0176.00		SPRING	1	
39	3003.0016.00		BALL 3/16"	1	
40	1210.0014.00		O-RING	1	
41	1210.0039.00		O-RING 1,78X 7,66 mm	1	

ITEM	PART No.	KIT	DESCRIPTION	Qty.	MODELS
42	0424.0316.00		HOSE BARB FITTING	1	
43	1210.0041.00		O-RING 1,78X 8,73 mm	2	
44	3605.0088.00		SPECIAL SCREW	1	
45	3200.0017.00		GRUB SCREW 1/8X8 mm	1	
46	3609.0148.00		SCREW M5X35	4	
47	3200.0017.00		GRUB SCREW 1/8X8 mm	1	
48	1210.0220.00		O-RING 2,0X4 mm	1	
49	3600.0087.00		CHECK VALVE	1	
50	1802.0177.00		SPRING	1	
51	3400.0287.00		INJECTOR	1	
52	1210.0041.00		O-RING 1,78X 8,73 mm	1	
53	1210.0152.00		O-RING 1,78X9,25 mm	1	
54	2000.0087.00		INJECTOR HOUSING	1	
55	1802.0189.00		SPRING	1	
56	3003.0015.00		BALL Ø7,938-5/16"	1	
57	1210.0152.00		O-RING 1,78X9,25 mm	1	
58	3009.0119.00		VALVE SEAT	1	
59	0009.0112.00		BACK UP RING	1	
60	1210.0041.00		O-RING 1,78X 8,73 mm	1	
61	0015.0169.00		PISTON ROD	1	WHITOUT ADJUSTABLE PRESSURE VALVE
	0015.0170.00		PISTON ROD	1	WHIT ADJUSTABLE PRESSURE VALVE
62	3021.0029.00		ELASTIC PIN Ø2X 10 mm	1	
63	1210.0055.00		O-RING 1,78X 6,07 mm	1	
64	0009.0110.00		RING 2025	1	
65	1210.0049.00		O-RING 1,78X 12,42 mm	1	
66	1210.0390.00		O-RING 2,0X17 mm	1	
67	3605.0089.00		HOUSING	1	
68	1802.0173.00		SPRING	1	
69	3202.0222.00		REG. SCREW	1	WHITOUT ADJUSTABLE PRESSURE VALVE
	3202.0228.00		REG. SCREW	1	WHIT DJUSTABLE PRESSURE VALVE
70	1220.0038.00		VALVE ASS.BLY	6	

For adjustable pressure valve only

ITEM	PART No.	KIT	DESCRIPTION	Qty.	MODELS
71	0009.0203.00		SNAP RING Ø3,2 mm	1	
72	1223.0089.00		HANDLE	1	
73	3605.0091.00		SPECIAL SCREW	1	
74	3622.0015.00		SCREW M4X10	1	
75	3202.0227.00		HANDLE CAP VRT2/15	1	